

CAN BATLLORI - HOSPITALET - VIVIENDA TIPO AT1 - LIBRE

AV/JOSEP TARRADELLES I JOAN, C/CANIGÓ, C/ENRIC PRAT DE LA RIBA, C/BATLLORI, HOSPITALET DE LLOBREGAT

CULMIA

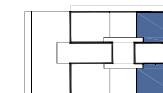
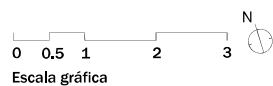

P 6,7,8

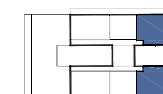

P 5

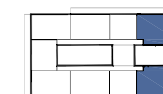

P 2,3,4

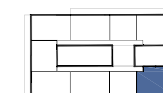

P 1



Puerta/s

Planta 1: 5
Plantas 2,3,4: 1,5
Plantas 5,6,7,8: 1,4
1,2,3,4,5,6,7,8
AT1 - LIBRE

Planta/s
Vivienda

Superficies

Útil interior aproximada 73.05 m²
Construida terraza 17.81 m²

Construida 85.29 m²
Construida con E.Comunes 103.76 m²

Superficies Útiles por estancia

1.Vestibulo	7.32 m ²	7.Dormitorio 3	7.22 m ²
2.Pasillo-Distribuidor	4.08 m ²	8.Baño 1	3.67 m ²
3.Cocina	8.97 m ²	9.Baño 2	3.54 m ²
4.Salón comedor	19.74 m ²	10.Lavadero	1.00 m ²
5.Dormitorio principal	10.42 m ²	11.Balcón	15.71 m ²
6.Dormitorio 2	7.09 m ²		

Can Batllori